

A guide to measuring

Creating the most accurate representation of your garden is important, it allows us to produce scaled designs that will work for the spaces you live in. It will also allow us to develop a more accurate cost for the materials required for the job. Here are some tips for giving us a clearer picture of your project:

- Use a good quality measuring tape/wheel (usually between 8 and 30 metres)
- **Tip:** be sure to record your measurements in CM/M as these metrics make it easier to calculate the cost of materials.
- Start with your house – measure the relative faces and plot in windows and doors – the rest of the drawing can be drawn square from this.
- **Example 1** shows a basic plan. To create an accurate picture of the space, it would be important to gain all the measurements suggested by the double arrows. Be sure to label everything, including existing flower beds, paths, trees and patios.
- **Example 2** shows a slightly more complex plan, where the garden isn't square. If your garden is irregularly shaped, break it down into simpler shapes like rectangles, squares, triangles, or circles. It is advisable to start with a rectangle, and then plot in the more complex shapes. As you can see in the example, it may be necessary to measure from the same point multiple times in order to measure complex shapes.
- **Please be sure to double check measurements before sending material over to us, and if you're struggling, advice is only a phone call away.**

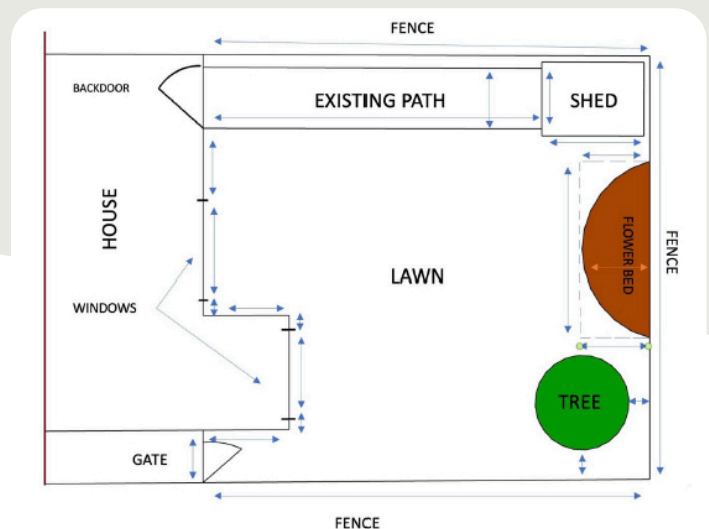

Example 1

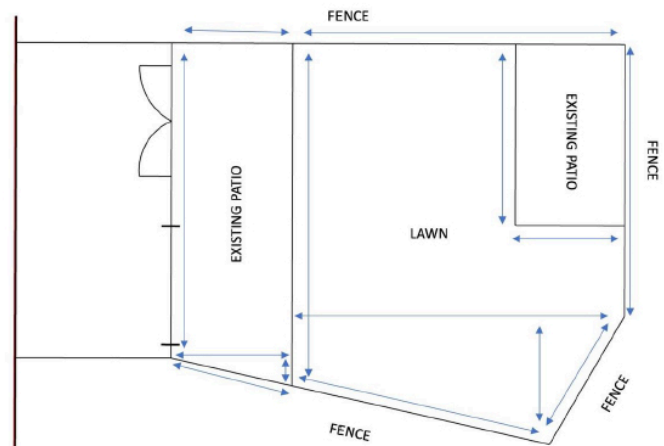

Example 2

ARCHLEY



Garden Design Service

Need some more assistance?

Call us on 01284 724486
or 07860 577557.

e: archleypaving@icloud.com